

# INSTRUCTION MANUAL

## INSTRUCTION MANUAL FOR THE FACE RECOGNITION TERMINAL **TAB-8897S**

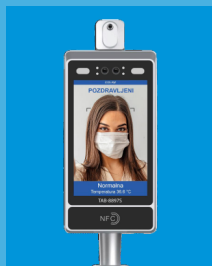

Thank you for purchasing a new product, you have chosen a quality one. This instruction manual is an integral part of the product. It contains important instructions for safety, use and disposal. Before using the product, read all the instructions for use and safety instructions. Use the product only as described and only for its intended purpose. If you give the product to someone else, hand over all the documentation as well.

### **INTENDED USE**

The device is intended for automatic measurement of facial skin (forehead) temperature and for face recognition (optional). It serves as a tool for preventive detection of fever on the skin surface. Product changes are not in accordance with the manufacturer's recommendations and may lead to accidents. The manufacturer accepts no liability for damage resulting from improper use.

### **SCOPE OF DELIVERY**

- 1x TAB-8897S device
- 1x 12V/2A power supply
- 1x cable set
- 1x instruction manual
- 1x bracket

## SAFETY INSTRUCTIONS

**Read the instruction manual before use. keep the instruction manual for future reference!**

### WARNING!

- Do not place any objects on the device.
- Never touch the adapter or device with wet hands.
- Protect the device from moisture and humidity. Never immerse the device in water or any other liquids.
- Make sure that the used plug socket is always accessible, as this is the only way to unplug the adapter in an emergency.
- Always pull the adapter out of the socket by holding the adapter. Never pull on the cable.
- To disconnect the power source, unplug the adapter.
- If the device will not be used for an extended period of time, unplug the adapter.

**Do not attempt to repair the device yourself. In the event of a fault, turn off the device, unplug the adapter and contact our service centre or repairman.**

- If the wiring to connect this device to the power supply is damaged, it must be replaced by the manufacturer or its service agent or a similarly qualified person in order to avoid a hazard.
- Do not pull on the power cable to move the product.
- Do not modify or repair the device.

**If the adapter is damaged, it must be replaced by the manufacturer or its technical customer service to avoid any risks.**

- The device is not suitable for children.
- Place the device on a flat or horizontal surface using a bracket or stand.
- Do not expose the device or the cable to heat and sharp edges.
- Do not use the device in potentially explosive environments containing flammable liquids, flammable gases or combustible dust.
- Keep the device away from direct sunlight.
- Keep the device away from radiators and other heat sources.
- Do not sit or step on the device.
- If you have not used the device for an extended period of time and you notice a burning smell upon startup, turn off the device, unplug the adapter and contact the seller.

## MAINTENANCE AND CLEANING

Unplug the adapter before each maintenance and cleaning.

Do not use aggressive chemicals or abrasives.

Clean the housing with a soft, dry cloth.

## TRANSPORTATION AND STORAGE

The device must be stored in a dry place, protected from external influences, in the temperature range from -10 °C to +45 °C, relative humidity 10 % – 90 %. Keep the device in its original packaging during storage.

The device may only be transported in its original packaging, protected from external influences (mechanical damage, water). During transport, the surroundings of the device must be dry, in the temperature range from -10 °C to +45 °C, relative humidity 10 % – 90 %.

## PRODUCT DESCRIPTION

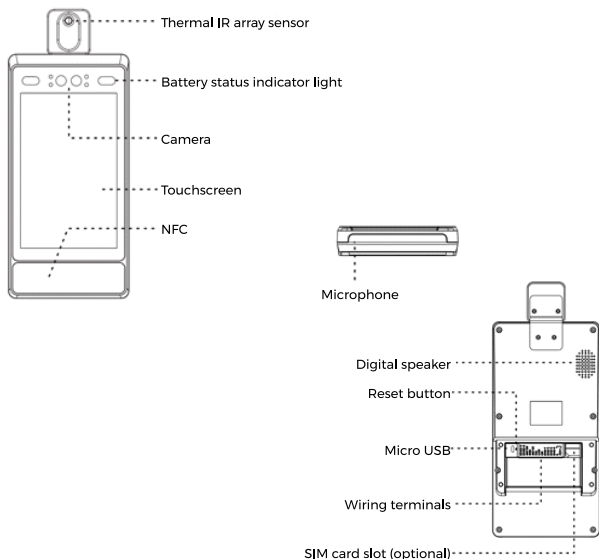



## DEVICE INSTALLATION

### Wall mounting

- Drill holes in the wall or other surface so that they match the holes in the mounting plate.
- Use the four supplied screws to secure the mounting plate on the wall.
- Route cables through the opening in the mounting plate and bracket, and connect them to the wiring terminals.
- Plug the wiring terminals into the device and use the 4 supplied M5 screws to attach the bracket to the device.
- Align the device with the mounting plate and buckle them together. Use the two supplied M3 screws to attach the device to the mounting plate.
- Adjust the tilt angle of the device according to your actual needs.

### Turnstile mounting

- Route the cable through the nut and cable holes on the turnstile pedestal's top panel, and route them through the bracket.
- Connect the cable with the terminals in the turnstile pedestal.
- Tighten the nut and secure the bracket.
- Plug the wiring terminals into the device and use the 4 supplied M5 screws to attach the bracket to the device.
- Adjust the tilt angle of the device according to your actual needs.

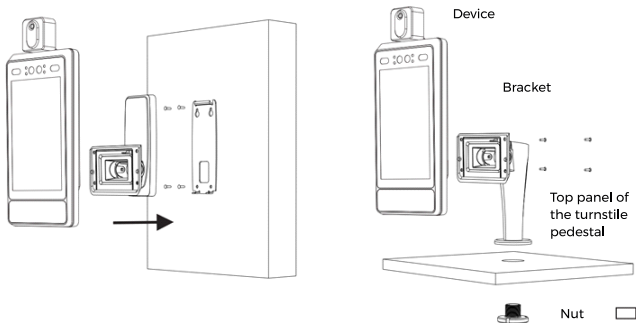

## HEIGHT AND ANGLE

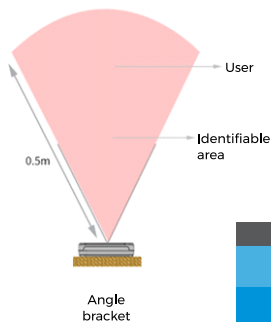

## CABLE CONNECTION

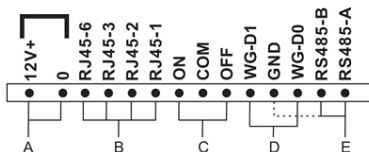

Group	Function	Colour	Name
A	Input power	Red (odebeljena) 2x Black (odebeljena) 2x	12V+ 0
B	RJ45	Grey Yellow Orange Brown	RJ45-6 RJ45-3 RJ45-2 RJ45-1
C	Door lock	Blue (thick) Green (thick) Yellow (thick)	ON COM OFF
D	Wiegand	Blue Rdeća	WG-D1 WG-D0
E	RS485	Black Green White	GND RS485-B RS485-A

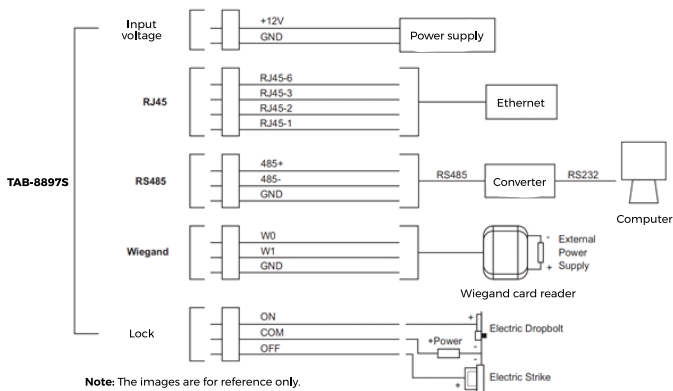

## INSTRUCTIONS FOR USE - Temperature measurement

### General

- With major temperature changes, the sensor does not work accurately: The meter may show a higher or lower temperature than the actual one (measurement error up to 5 °C) or report an error.
- The device must be kept at a constant temperature between 15 °C and 30 °C.
- To ensure the best performance, we recommend measuring at room temperature.
- When transferring the device from a cold area to a warm area, the lenses may fog up, which may lead to an incorrect measurement result.
- For proper operation of the device, it is necessary that the device is in the room where the measurement will be performed for at least 30 minutes before the actual measurement. This allows the device to heat up/cool down to room (ambient) temperature. After mounting or moving the device to another location, it must be left in operation for at least 30 minutes before use.

### Distance for temperature measurement

- The most suitable distance for measuring skin temperature: 0.5 m.
- The recommended distance for measuring skin temperature is from 0.5 m to 0.7 m.
- Failure to follow the recommended range leads to higher measurement uncertainty.

### Part of the body for temperature measurement

- To ensure accuracy in skin temperature measurement, the temperature is measured on the forehead.

### Temperature measurement instructions and warnings

- To ensure an accurate measuring area during temperature measurement, the forehead must be correctly positioned within the face frame on the LCD screen of the TAB-8897S.
- DO NOT move your forehead during the temperature measuring process.
- Make sure there are no obstructions (such as hat or hair) or sweat on the forehead during the temperature measuring process. We recommend that no cream, powder or other ointment be applied to the forehead before the measurement.
- DO NOT wet the forehead with cold water or hot water before the temperature measuring process.
- DO NOT suddenly take off your mask or glasses during the temperature measuring process.
- After drinking warm water/feeding/sleeping/exercising, wait 30 minutes before measuring temperature.
- Before each use, the person wishing to perform the measurement must acclimate to the ambient temperature, eliminate previous external influences (heat and cold), and return their skin temperature to a normal state (e.g. for a person who has been in the cold for a long time, the radiant temperature of the forehead may decrease, so the measurement is not accurate)
- Any increase in physical activity can affect the measurement result (higher measurement error).
- For people who have cream, powder or other ointments on their foreheads, the measurement error may be higher.

## Additional precautions

- To ensure an accurate measuring area during temperature measurement, the forehead must be correctly positioned within the face frame on the LCD screen of the TAB-8897S.
- The device must not be exposed to sunlight.
- In the case of wall mounting, we recommend that people do not stand one behind the other or in the field of view of the device.
- Wait for the device to return to standby mode before each new measurement (background image).
- Upon each startup, you need to run the application on the desktop in Android (if it does not start itself).
- When mounting on a stand, it is necessary to choose the correct angle for smooth running regardless of the user's height. You must wait for the device to return to standby mode (background image) before reusing it.
- We recommend that you do not expose the device to air conditioners, direct air drafts and light fixtures.
- Lingering in the area where the device is set and in its field of view interferes with the proper functioning of the device.
- The product is intended for offline use. The manufacturer, importer, distributor and seller assume no liability for any damage that may result from use of the product online. In particular, they assume no responsibility for the security of personal and other data in the event of using the product online. Ensuring the security of personal and other data against unauthorised access by third parties or the transfer of personal and other data is in any case the duty of the user.
- The product is not intended for use in potentially explosive environments.
- The product is an electronic device designed for automatic non-contact forehead temperature measurement. The product detects the area on the forehead where the temperature is highest.
- To ensure the most accurate measurement results, the product must be mounted or installed in accordance with the manufacturer's instructions.
- The product is not designed to measure internal body temperature.
- The product is not intended for medical use.
- The product is not a medical device.
- The product is not a diagnostic tool for diagnosing diseases.
- The product is not intended to treat any disease.
- If the product indicates high fever on the skin surface, the user is advised to measure their body temperature with a medical device and consult a doctor if necessary.
- In no case can the use of the product replace the measurement of body temperature with a medical device and a clinical examination by a doctor.
- The product is not intended to diagnose the new coronavirus infection (SARS-CoV-2) or COVID-19 disease.
- The product is not intended to diagnose past contact with the new coronavirus (SARS-CoV-2) or past COVID-19 disease.
- Body temperature can vary during the day. It can also depend on a person's physical activity. Increased body temperature does not necessarily mean that a person is ill. Increased body temperature does not necessarily indicate that a person is infected with the new coronavirus (SARS-CoV-2) or that they have COVID-19. Increased body temperature can also be caused by another illness or non-disease condition. The absence of fever does not necessarily mean that a person is not infected with the new coronavirus (SARS-CoV-2) or that they do not have COVID-19.
- Infection with the new coronavirus (SARS-CoV-2) is proven by appropriate laboratory tests and not by measuring body temperature or forehead temperature.
- The device does not provide complete security against possible abuse. If you need a higher level of security, use additional security methods.

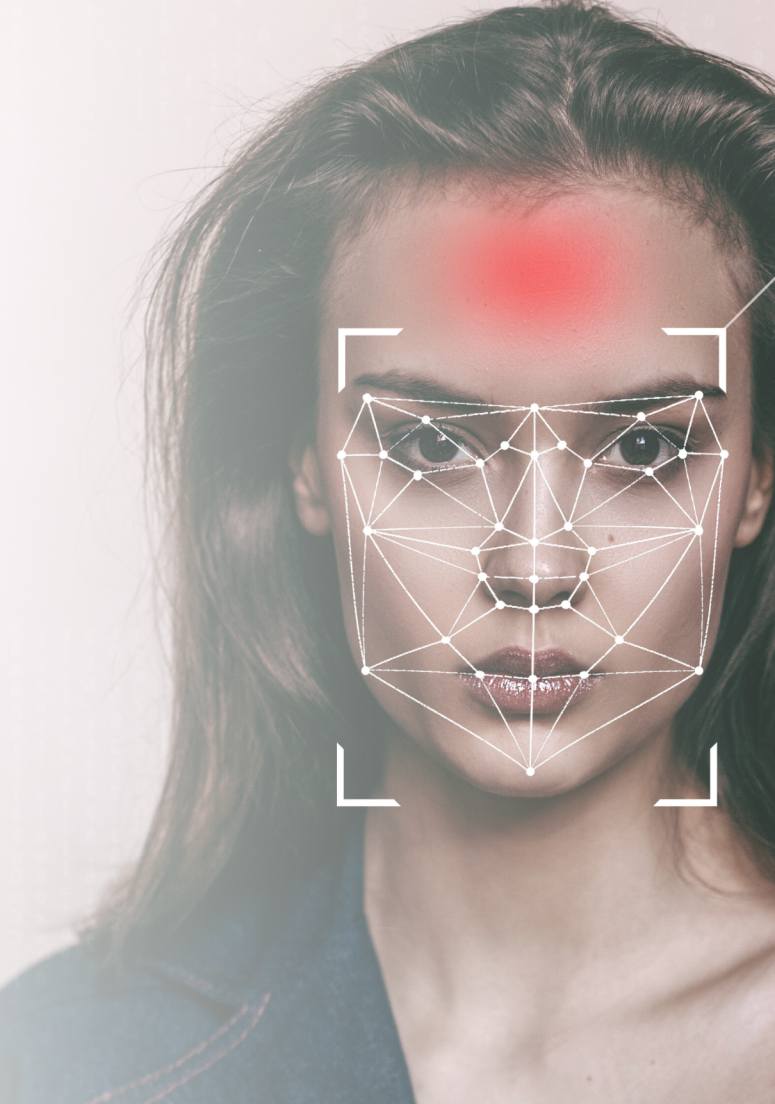

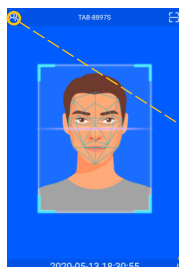

## USE OF THE APPLICATION

Connect the device to the power supply. The TAB-8897S application will open automatically when the device is started. You can also activate the application manually by pressing the TAB-8897 icon.

### System activation

Click the icon in the upper left corner where you will enter the password.

### System login

Enter the default initial password "123456" in the Password field and click "Confirm" to open the appropriate settings page.

Click "Activate" to activate the device. An example of successful activation is shown in the figure.

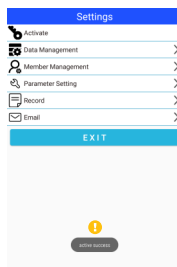
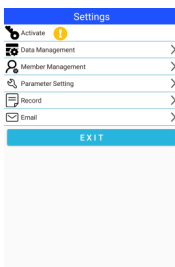
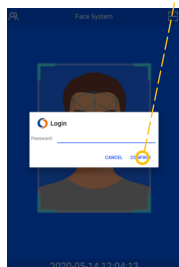

## DATA MANAGEMENT

Click "Data Management" to open the data management page.

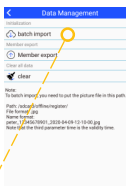
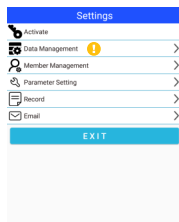

Click "Batch import" to begin importing data. To import data at this location, insert the image according to the steps above. When the data import is completed, it is shown as the result of the data import. \* Watch image No. 2

**Note:** An image must be created beforehand to successfully import data

\* Watch image No. 3

## Data import troubleshooting

If the data processing fails, you can view the failed face information from the failure list of the face information management page after importing the database.

**To resolve this issue, check the following:**

I. Was the engine successfully activated

II. The image does not meet the requirements:

Does the face information picture imported by the server comply with the specifications (.jpg)? You can export existing images to the offline/member folder by selecting "Export members". The option "Remove" allows you to delete images and database (Figure 3).

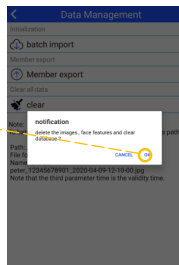

## MEMBER MANAGEMENT

In the Member Management menu, you can add users who need to register. To register a user, select the blue icon shown in Figure 2.

Clicking on the icon shown in Figure 3 opens up a screen for photographing the face.

The user takes a photograph of the face by approaching the screen and clicking to confirm image capturing. Then the user enters a name, serial number and date and time of registration.

**Warning:** By capturing an image and registering, the user or device administrator allows the device to recognise the person's face during the next measuring or use. Entries of registered users are stored in the device.

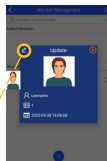
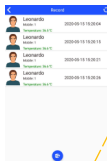
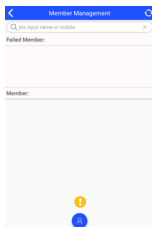

By clicking REGISTRATION (Figure 1), the user is successfully saved.

Examples of successfully saved users can be seen in Figure 2.

You can update user data at any time. You can update or edit a user by clicking on them. (Example: Leonardo, Figure 3)

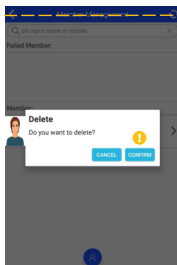
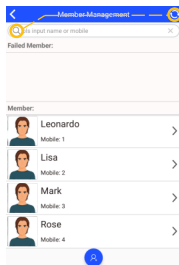

You can search for existing users by name or by serial number. You can easily erase users by pressing/holding the user and confirming.

## PARAMETER SETTINGS

Click the Parameter Settings option to enter the parameter settings page. In the menu, you can change the password to access the application. We recommend that you do this as soon as you activate the device.

You can change all parameter settings as you wish.

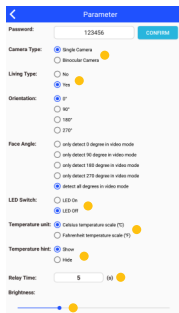

### Camera type

- Camera (2M pixels)
- Dual camera (2M pixels + IR)

### Living type

- Presence detection

### Orientation

- Camera display layout

### Face angle

- Face detection

### LED operation

### Temperature unit (°C ali °F)

### Temperature display

Yes/No

### Relay rule

- Temperature (activation for everybody)
- Temperature & Face (activation for users only)
- Face (activation for users, without temperature measurement)

### Status bar

- Show or hide (device access lock)

### Navigation keys

- Show or hide (device access lock)

### Relay time

### LED Brightness adjustment

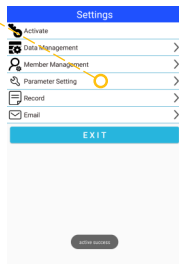



## RECORD

Click "View Data" to access data overview.

Registered users can be exported. The device records only the data of registered users.

To export, you must select the date or month for which you want to export the data. The device records registered user data (time and date, name, serial number, picture, temperature – optional).

By confirming, the data is exported to sdcard/offline/record.

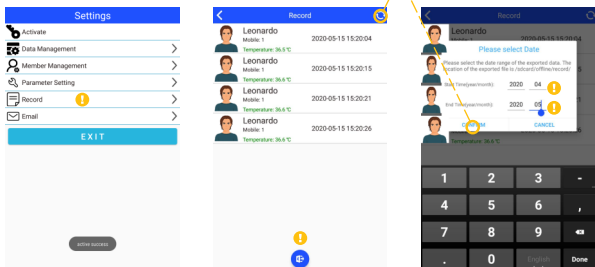

## EMAIL (optional)

By clicking "Email", you can manage your email settings. You can add up to 10 email addresses to which you want to send information if you suspect that a registered user has a fever.

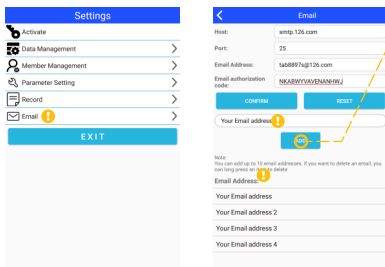

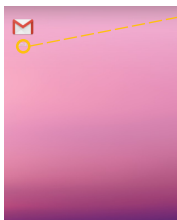

## SUBMITTING DATA

All registered user data can be exported according to the procedure shown below. Set up any email address on your device (example below: Gmail).

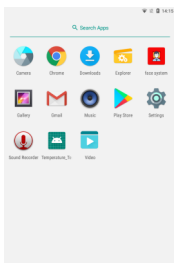

In the case described, the user or device administrator exports the data from the Data Overview menu.

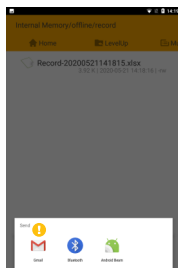
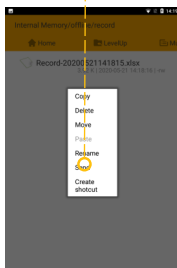
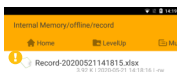

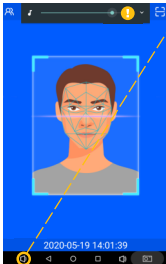

## ● VOLUME ADJUSTMENT

Click option "Volume" to access volume settings.

## CLOCK AND DATE SETTINGS

Enter main menu on Android application to manage date and time as shown below.

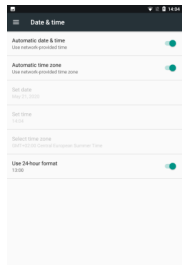
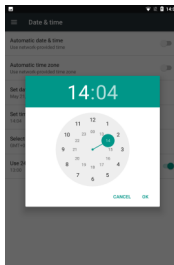
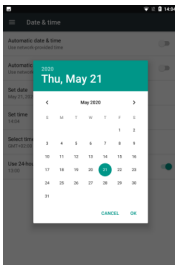
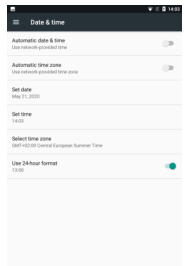
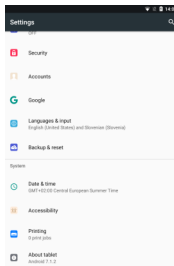
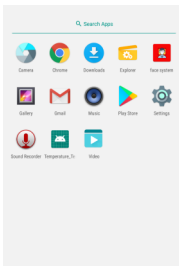

## TROUBLESHOOTING

### Troubleshooting table

Problem	Possible cause	Solution
<b>The screen is not responding or does not work</b>	The product is not connected to the power supply Power failure The application is not responding	Insert the plug into the socket Wait for the power to return Close the application and restart it
<b>Measurement failed</b>	Background interferences, unsuitable environment, incorrect positioning of the device or user, external or internal interferences, IR sensor error	One person should be placed in front of the device (in its field of view) so that the measuring area of the face is within the frame of the screen Proper placement of the device so that there are no internal and external temperature or light influences Replacement of the temperature sensor at an authorised service centre

If the measurement was not successful, this may mean:

- That the measured skin temperature is lower than 35.7°C
- Influences of external and internal factors, according to the instructions for use

## DISPOSAL

**Important information for proper disposal of used equipment and batteries. Only for EU countries and countries where a waste recycling system is in place**

**Marking:**

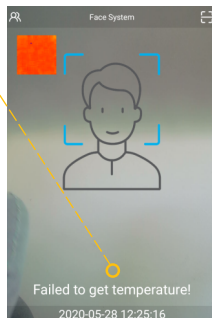

This marking indicates that the product should not be disposed of with household waste throughout the EU. To prevent possible harm to the environment or personal injury from uncontrolled waste disposal, recycle the product responsibly to promote sustainable recycling of raw materials. To return your used device, use local return and collection systems or contact your seller. The seller can take the product to an environment-friendly recycling centre.

These symbols are valid only in the European Union.

## TECHNICAL DATA

<b>Processor</b>	Dual-core 1.8GHz + quad-core 1.4GHz
<b>Internal storage</b>	4GB RAM, 16GB FLASH
<b>Operating system</b>	Android 7.1
<b>Screen</b>	LCD touchscreen: 8 inches, resolution 1280 * 800 pixels
<b>Camera</b>	Dual camera (RGB + IR)
<b>LED light</b>	White LED
<b>SIM slot</b>	1 SIM / optional
<b>Communication</b>	Ethernet/Wi Fi/Bluetooth
<b>Peripheral units</b>	DC input power × 1, Micro USB × 1, RJ45 × 1, lock × 1, Wiegand × 1, RS485 × 1
<b>Audio</b>	Digital speaker, microphone
<b>Power supply</b>	12V/2A
<b>IR thermal sensor</b>	Up to $\pm 0.3$ °C, at a distance between 0.5 and 0.7 m
<b>Temperature</b>	from -10 °C to 45 °C
<b>Humidity</b>	10 % – 90 % (no condensation)
<b>Dimensions</b>	323 mm × 135 mm × 30 mm (without bracket)

## MANUFACTURER, IMPORTER AND DISTRIBUTOR

Manufacturer: **\*Confidential\***

Importer: **BILCOM SI, merjenje in regulacija temperature, d.o.o.**  
**Prvomajska ulica 35, 3250 Rogaška Slatina**

Distributor: **Arona Kreativa d.o.o., Ob železnici 22, 1000 Ljubljana**

## OFFICIAL SERVICE

Bitcom d.o.o., Krivc 5, 1000 Ljubljana, Phone: 01 519 77 96, 040 13 11 13, email: servis@bitcom.si

## WARRANTY TERMS

The manufacturer guarantees the quality or flawless operation of the product during the warranty period. The warranty period lasts 1 year and begins on the day of purchase or delivery of the product to the customer. The warranty applies only to products purchased in the territory of the Republic of Slovenia. When making a claim under the warranty, the customer must submit an invoice and a completed warranty card. The manufacturer guarantees free elimination of defects resulting from material or manufacturing defects by repairing the product or replacing it with a new, faultless one. If the repair cannot be carried out within 45 days, the product will be replaced with a new faultless one. The warranty period is extended for the time it takes to repair the product. After the expiration of the warranty period, the manufacturer is obliged to provide servicing and spare parts for a period of 3 years after the expiration of the warranty period. The warranty does not exclude the customer's rights arising from the seller's liability for defects in the goods. After receiving of the product for repair, the service company and the seller do not take responsibility for the stored data or settings. Repairs made after the expiration of the warranty period are payable according to the price list of the authorised service centre. In order for coverage to be approved, the defect or non-functioning of the product must be caused by the properties of the product and not by circumstances outside the scope of the manufacturer or seller.

### **This warranty does not cover damage and/or defects caused by:**

- force majeure, accidents, unforeseen events (such as lightning, water, fire, etc.),
- improper use or improper transport of the product, failure to follow the instructions for assembly and use of the product (e.g. mechanical damage: damage caused by sharp objects, twisting, squeezing, falling, etc.),
- failure to comply with safety and/or product maintenance instructions,
- repairs and/or alterations and/or modifications made to the product by an unauthorised service centre and/or unauthorised person (e.g. if the product has been opened, modified or repaired by anyone other than an authorised service centre, if the product has been repaired using unapproved spare parts or if parts have been removed, erased, distorted, altered or the serial number is illegible),
- normal wear and tear/use of the product (scratches, abrasions, wear on the camera lenses and screen, etc.),
- using or connecting the product with any product, battery, accessory, software and/or services of other manufacturers and providers,
- connecting the product to incorrectly installed or defective accessories,
- use of the product for any purpose other than intended, viruses and other malicious programs, unauthorised access to services, computer systems or networks by you or by a third party,

### **This warranty also does not apply to:**

- wearing parts or consumables,
- instruction manuals, settings, contents, data or links, whether installed in the product at the time of purchase or later,
- slight deviations (defects) of the colour screen. Up to two black and two coloured dots at a distance of more than 5 mm shall be considered as minor defects,
- exposure to moisture, humidity, extreme heat or other environmental conditions, rapid changes in these conditions, corrosive effects, oxidation, spillage of food or drink or exposure to chemical agents,
- if the information on the warranty card or invoice has been changed or corrected.